

Xtra II by Elsafe

Affordable Security with Quality

The choice of in-room electronic safes becomes easy when you can choose Xtra II by Elsafe to secure your guests' belongings.

Xtra II is advanced and economical security, with the industry's leading audit trail system that allows you to print out comprehensive reports on all safe activities.

Now, Xtra II by Elsafe comes in a NEW improved design to complement your hotel room regardless of style.

NEW



FEATURES:

- Industry-leading audit trail.
- Audit trail with in-room print-out option.
- Flash memory.
- ADA compliant telephone-style keypad.
- 4-digit guest code.
- LED display for clear visible numbers.
- Backlit keypad option.
- Push button to close door.
- Powered with 5 LR6/AA batteries.
- Easy outside battery change.
- Spring loaded door.
- 6 models (27/43/50 cm, Floor, Drawer, On-wall)
- Laptop compatible up to 17" (for XD50 and XD70 Floor safe).
- Serviced by SafeLink or PinKey PLUS.
- Support IR communication.
- Anti-tamper labyrinth.
- 18mm solid steel bolt locking mechanism.
- Inside carpet.
- Internal power outlet option (UK/US/EURO).

SPECIFICATIONS

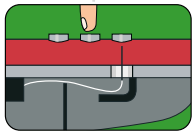

Anti-tamper labyrinths offer higher protection against manipulation.



Spring-loaded door indicates if the door is in open or closed position, avoiding guests leaving the safe open unintentionally.

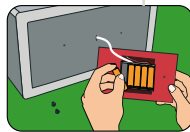

Quick battery change without having to open the safe. It saves time and money.

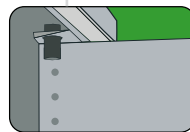

Solid one-piece construction enhances security and eliminates access to vital components.



Safelink:

Elsafe Safelink helps you set up and service your Xtra II safe in seconds. With Xtra II by Elsafe you can even print a detailed 100-event log from the safe memory.

PinKey PLUS:

Elsafe PinKey PLUS is a compact and powerful electronic PIN-code protected, non-resident master key to securely override Elsafe in-room safes. This allows for easy day-to-day safe operations.



Additional Xtra II safe models:

Xtra II by Elsafe is also available in the following models:



Floor Safe



Drawer Safe



On-wall Safe

Outlets:

Optional internal power outlet on inside door available on Xtra II 27, 43 and 50. (EURO, US and UK).



Sizes 27, 43 and 50 cm are external depth

* Measurements		XD 27	XD 43	XD 50	XD 70 Floor safe	DD 13 Drawer safe	WD 13 On-wall safe
External dimensions (h/w/d) incl. keypad	mm inches	194/357/272 7 ⁵ / ₈ /14/10 ¹¹ / ₁₆	194/357/434 7 ⁵ / ₈ /14/17 ¹ / ₂	194/357/512 7 ⁵ / ₈ /14/20 ³ / ₁₆	536/355/458 21 ¹ / ₈ /14/18 ¹ / ₁₆	132/400/350 5 ³ / ₁₆ /15 ³ / ₄ /13 ³ / ₄	350/400/132 13 ³ / ₄ /15 ³ / ₄ /5 ³ / ₁₆
Internal dimensions (h/w/d)	mm inches	188/351/192 7 ³ / ₈ /13 ¹³ / ₁₆ /7 ⁹ / ₁₆	188/351/354 7 ³ / ₈ /13 ¹³ / ₁₆ /13 ¹⁵ / ₁₆	188/351/432 7 ³ / ₈ /13 ¹³ / ₁₆ /17	500/349/371 19 ¹¹ / ₁₆ /13 ³ / ₄ /14 ⁵ / ₈	63/397/347 2 ¹ / ₂ /15 ¹⁰ / ₁₆ /13 ¹¹ / ₁₆	347/397/63 13 ¹¹ / ₁₆ /15 ¹⁰ / ₁₆ /2 ¹ / ₂
Door dimensions (h/w)	mm inches	140/295 5 ¹ / ₂ /11 ⁵ / ₈	140/295 5 ¹ / ₂ /11 ⁵ / ₈	140/295 5 ¹ / ₂ /11 ⁵ / ₈	455/220 17 ¹⁵ / ₁₆ /8 ¹¹ / ₁₆	340/225 13 ⁶ / ₁₆ /8 ¹⁴ / ₁₆	340/225 13 ⁶ / ₁₆ /8 ¹⁴ / ₁₆
Internal volume	liters cu ft	13 0,46	24 0,84	28,5 1,01	66 2,33	9 0,32	9 0,32
Weight	kg lb	7,8 16,8	10 21,6	11,6 25,6	36,2 79,8	14 30,9	14 30,9

H/W/D: Height/width/depth

- Override: Safelink and PinKey PLUS
- Steel thickness (27/43/50): Door: 4 mm / Frame-Backwall: 2 mm / Body: 1,5 mm
- Fastening method: Backwall: 2 bolts / Bottom: 4 holes

Affordable Security with Quality

Contact us:

Xtra II

by Elsafe®



ASSA ABLOY

VingCard Elsafe AS
P.O. Box 511 • 1522 Moss • Norway
Tel: +47 69 24 50 00 • Fax: +47 69 24 50 50
E-mail: info@vcegroup.com • Internet: www.vcegroup.com

Specifications may change without notice.

ASSA ABLOY